

# RAVAS 520

## Hand Pallet Jack

MOBILE  
WEIGHING  
SYSTEMS

If your material handling process includes piece counting or repeatable steps, the RAVAS 520 advanced scale functions will save you valuable time. With an intuitive touch screen display, multiple weighing functions, wireless connectivity, and Lithium-ion powered battery, the RAVAS 520 will enhance your warehouse operation.

### Advanced Functionality

- Standard NTEP approved
- 5" touch screen with easy to read digits
- Power supply by a rechargeable and removable Li-ion battery
- Programmable routines
- Standard with piece counting function
- Integrated data connectivity

Effortlessly lift and drive with handle controls

Intuitive touch screen display with 0.98 inch high digits. Only the active keys are visible



Level compensation to 3 degrees

# RAVAS 520

## FUNCTIONS

- Automatic and manual zero correction
- Gross/net weighing
- Tare memory for 10 values
- Internal clock for date and time
- On board:
  - RS232 port connection for printer
  - USB output for data transfer (with USB stick)
  - Free COM1 and COM2 for RS232, WiFi or connection to devices that have Bluetooth® technology
- The USB output can also be used to connect a bar-code scanner
- Connectivity for RAVAS Indicator App

## STANDARD SPECIFICATIONS

### WEIGHT CAPACITY

- 5,000 lb.

### GRADUATION

- 0 - 3,000 lb.: graduation 1 lb., or 5,000lb.: graduation 2 lb.

### MAXIMUM TOLERANCE

- 0.1 % of applied load

### DISPLAY

- Full-color 5" touch display with 1" high digits

### POWER CONSUMPTION

- 14.8V - 160 mA

### POWER SUPPLY

- Li-ion battery pack 14.8V/5Ah incl. charger

### AUTONOMY

- 25 hours continuous use (50 hours with sleep modes)

### KEYBOARD

- Display mode defines the available keys, on/off key

### PROTECTION CLASS

- Loadcells NEMA 5, indicator NEMA 4

### INDICATOR MOUNTING

- Rotating and tiltable

### STEERING WHEELS

- Rubber

### LOADING WHEELS

- Polyurethane, single

### COLOR

- Red (RAL3000) epoxy painted

### PUMP

- Quick lift

### OWN WEIGHT

- 255 lb.

## DIMENSIONS

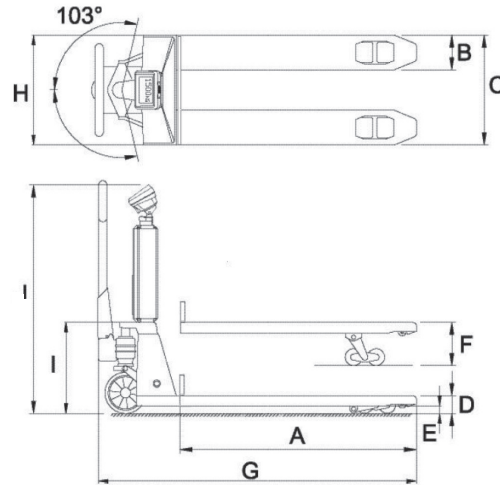

<b>A</b>	Fork Length	48"
<b>B</b>	Fork Width	7.1"
<b>C</b>	Width Over Forks	27.2"
<b>D</b>	Minimum Fork Height	3.35"
<b>E</b>	Minimum Clearance	0.7"
<b>F</b>	Maximum Fork Height	7.9"
	Lifting Height	4.8"
<b>G</b>	Overall Length	64.8"
<b>H</b>	Width Over Forks	27.2"
<b>I</b>	Minimal Chassis Height	17"

Tolerance +/- 0.1"

## OPTIONS\*

- NTEP version (2nd half of 2020)
- Thermal or matrix printer 12V
- Wireless or WiFi data transfer
- Reference scale via RS232 (for more accurate piece counting)
- Parking brake
- 1D USB bar-code scanner, not in combination with legal for trade
- Additional Li-ion battery pack
- Stainless steel chassis
- RDC, RAVAS Data Collector Software
- RIS, RAVAS Integration Software

\*The use of options may change related specifications.

